

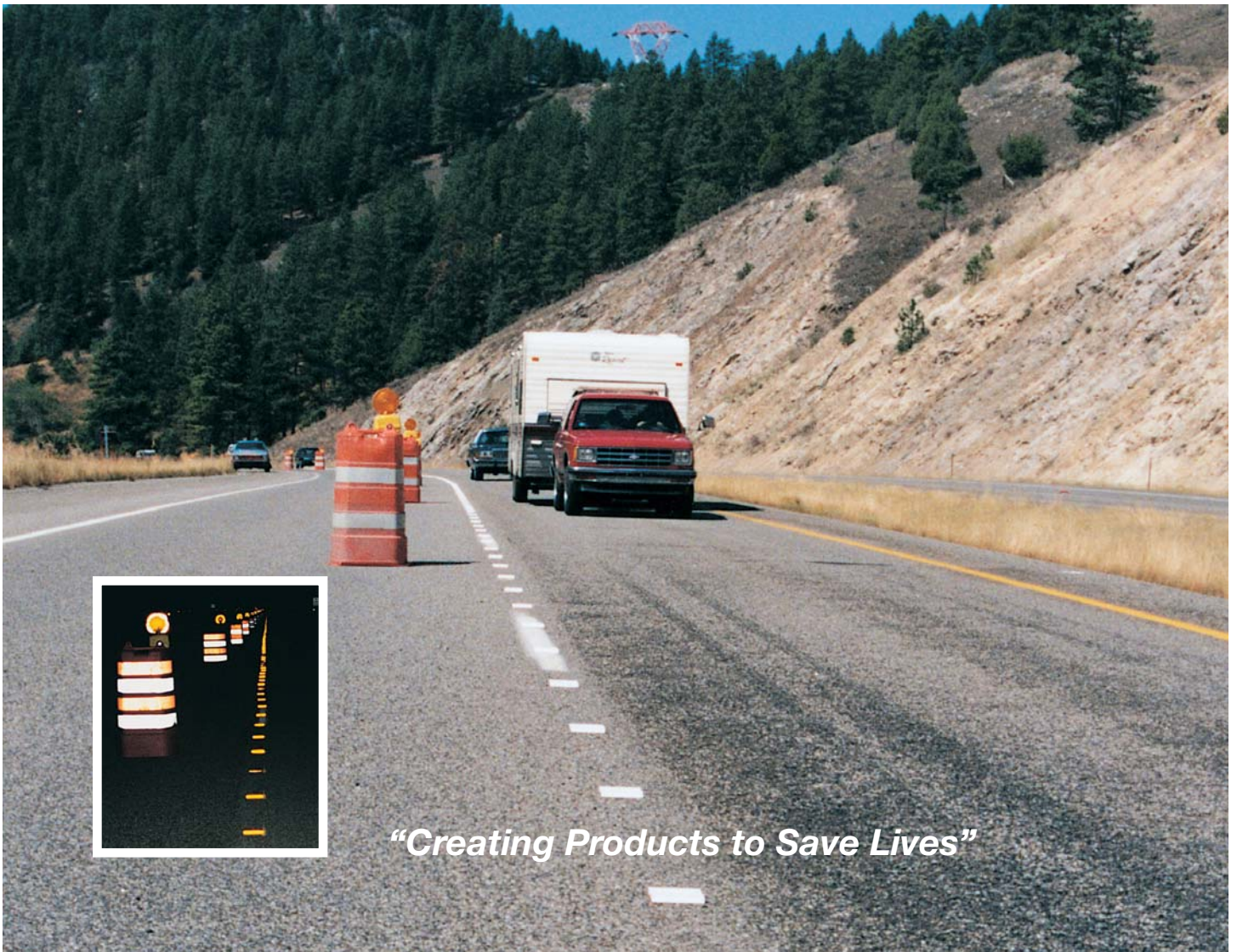

Davidson Traffic Control Products

# RPM and Halftrack Markers

Durable Work Zone Pavement Markers



*"Creating Products to Save Lives"*

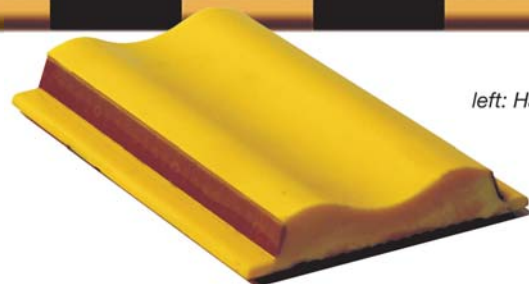

left: Halftrack Model 26

# Davidson RPMs and Halftracks take what your Work Zones dish out

## Visible in Dangerous Work Zones

Higher visibility at longer distances means more preview time for drivers to see, think and react as they drive through hazardous work zones. The brightness of pavement markings becomes more critical as drivers age. Work zones are much safer when the lanes have been clearly delineated with Davidson **RPM** and **Halftrack** Durable Work Zone Markers.

**Night driving** is especially dangerous in work zones. RPMs and Halftracks utilize a highly efficient cube-corner microprism reflector which makes them three times brighter than other markers.

Our Work Zone Markers outshine tape and paint, especially on rainy nights when tape and paint disappear under a film of water.

**RPM Model 35** The 4"x4", double domed surface of our standard RPM creates a dramatic rumble effect, alerting motorists of lane change.

**Halftrack Models 25 & 26** Roughly half the size of our RPMs, Halftracks offer an inexpensive way to augment painted lines and tape, greatly improving the nighttime visibility.

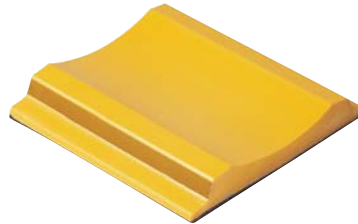

RPM  
Model 35

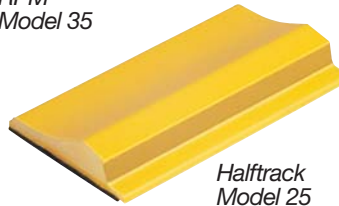

Halftrack  
Model 25

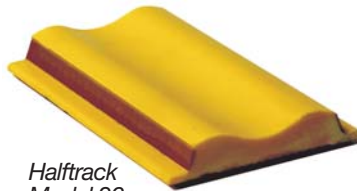

Halftrack  
Model 26

**Reliable Adhesion to the Road**  
Reliable adhesion is very important to initial installation, critical to the long term performance of a marker and also means less time will be spent replacing missing markers. Reliable adhesion is engineered into

the RPM and Halftrack from the start. The bases of our markers feature our exclusive Gripper/Grabber pattern which increases surface area to twice that of hollow markers. More surface area in contact with the adhesive equals more reliable adhesion. Designed for use with factory-applied butyl pads, epoxy, or hot melt bitumen, you can depend on the RPM and Halftrack to be there working for you long after they are installed.

## Unique Design of Our Markers Offers Superior Durability

The RPM and Halftrack are unique designs in raised markers, engineered to meet the challenges of today's tough work zone conditions. In order to withstand the impact of car and truck tires, the solid, unibody construction of our markers eliminates hollows. The unibody design resists crushing under the weight of even the heaviest vehicles.



## Davidson Traffic Control Products

"Creating Products to Save Lives"

3110 70th Avenue East Tacoma, WA 98424 / (877) 335 4638  
e-mail: hwysales@pexco.com [DavidsonTraffic.com](http://DavidsonTraffic.com)

